

FAG H240/1000-HG参数

尺寸	D_m	1140	mm	-
	l	562	mm	-
	c	100	mm	-
	c_1	122	mm	-
	d	1000	mm	-
	d_{2G}	Tr1000x8	mm	-
	e	10	mm	-
	R_o	G1/8		-
	t	12	mm	-
说明		950	mm	轴
		HM30/1000		型号, 螺母
		MS30/1000		型号, 止动装置
		M20X40		型号, 六角头螺栓
重量	m	539000	g	质量
尺寸	d_{1H}	950	mm	-

FAG H240/1000-HG图片

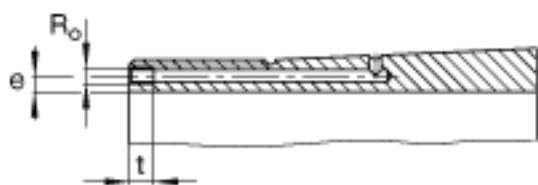

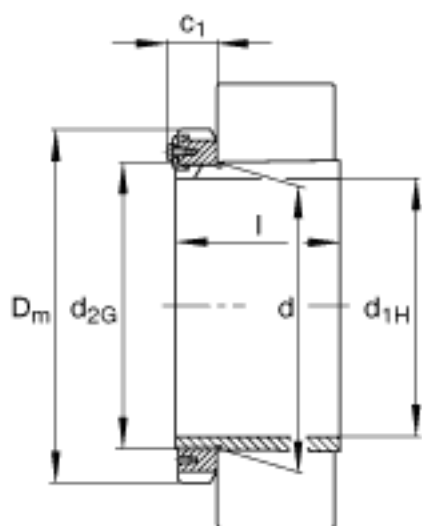

参考资料:<http://www.sozhou.com/p/6131d63f.html>