

TIMKEN 200RU30参数

轴承型号	Part Number	200RU30		-
	Subtype	NU		-
尺寸	d	200	mm	内径
	D	309.999	mm	外径
	B	81.9988	mm	宽度
额定载荷	C1	1049780	N	一百万转动态径向载荷
	C0	1530188	N	静态额定载荷
几何结构系数	Cg	0.2125		几何系数
极限转速	oil	2300		润滑油
	grease	1800		润滑脂
尺寸	R	2.032	mm	最大轴肩倒角半径
	da	219.964	mm	轴肩直径
	r	2.032	mm	最大轴承座挡肩圆角半径
	Da	289.814	mm	轴承座挡肩直径
重量	Assembly Weight	23586.80	g	-

TIMKEN 200RU30图片

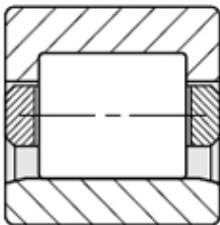
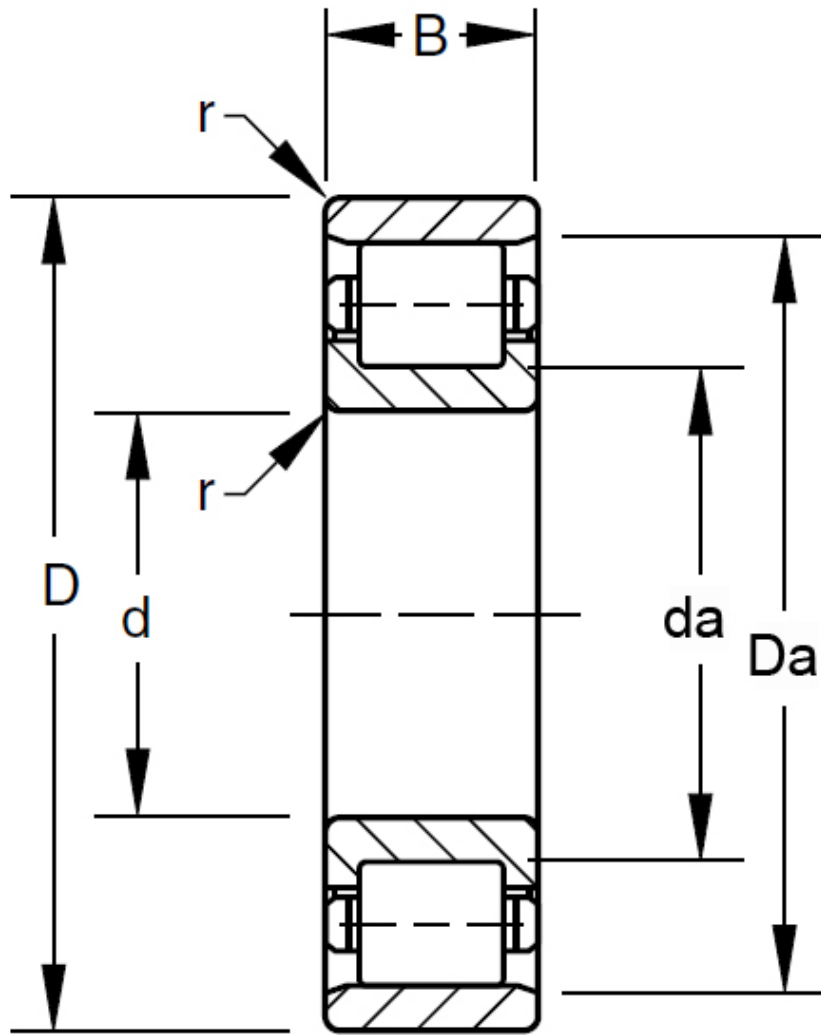

RU
RIU

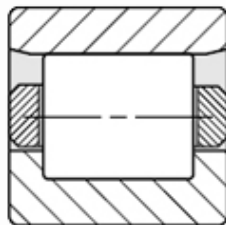

RN
RIN

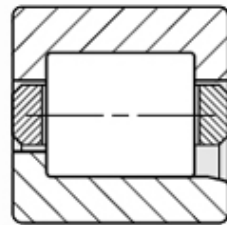

RJ
RIJ

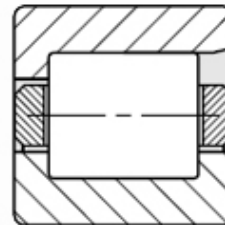

RF
RIF

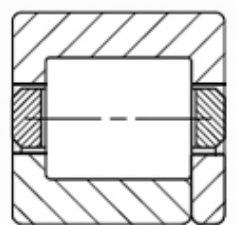

RT
RIT

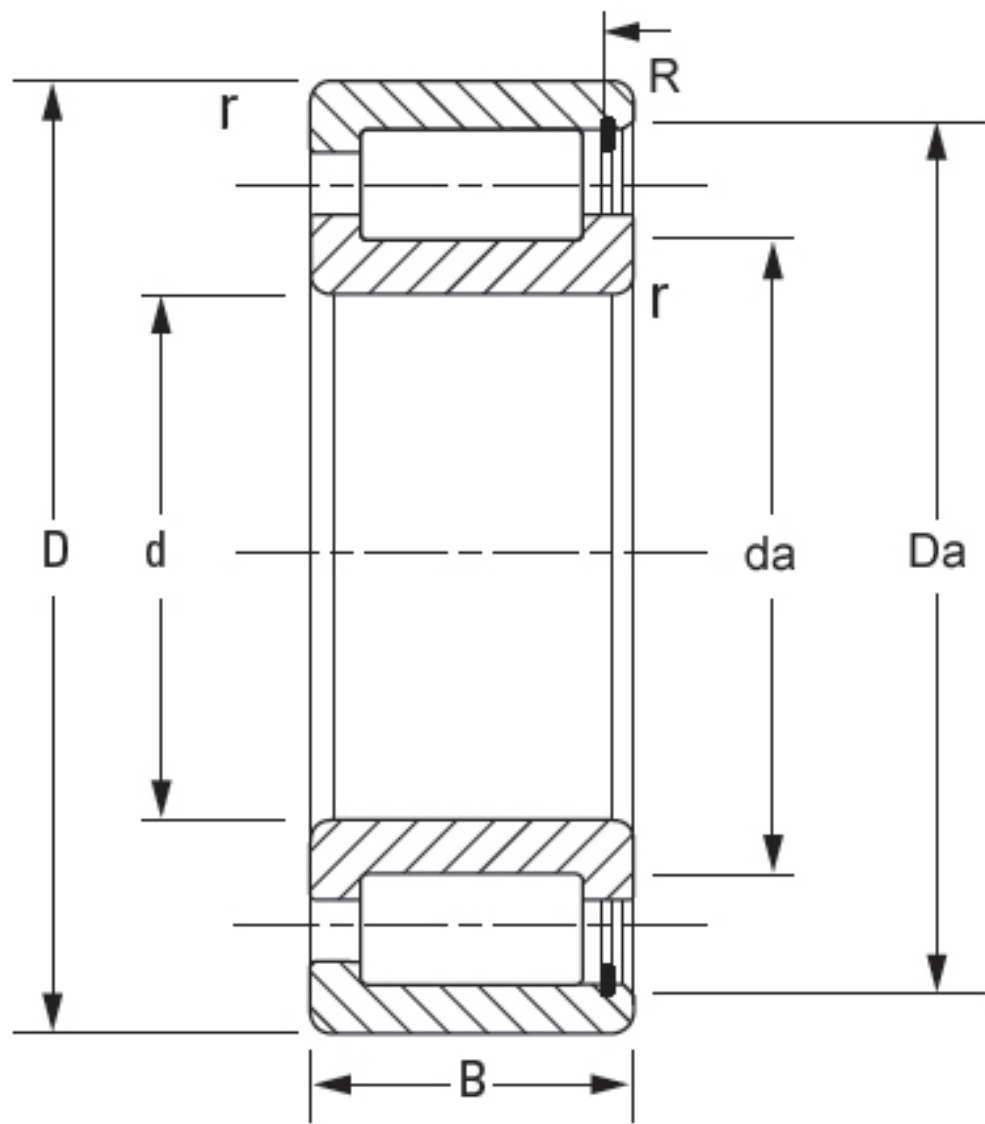

NCF