

FAG H240/1250-HG参数

说明		M20X40		型号, 六角头螺栓
重量	m	988000	g	质量
尺寸	d_{1H}	1180	mm	-
	D_m	1390	mm	-
	l	660	mm	-
	c	110	mm	-
	c_1	132	mm	-
	d	1250	mm	-
	d_{2G}	Tr1250x8	mm	-
	e	14	mm	-
	R_o	G1/4		-
	t	15	mm	-
说明		1180	mm	轴
		HM30/1250		型号, 螺母
		MS30/1000		型号, 止动装置

FAG H240/1250-HG图片

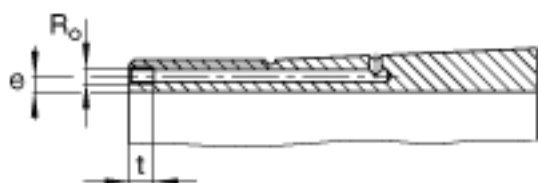

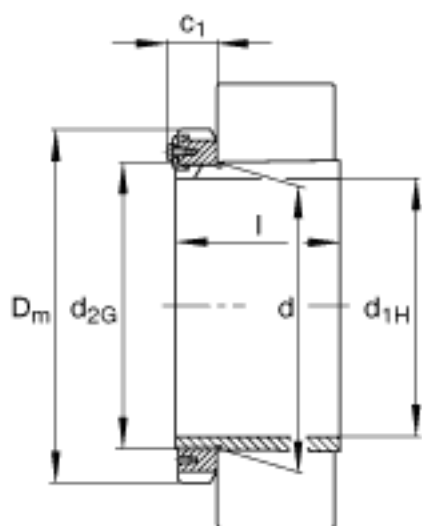

参考资料:<http://www.sozhou.com/p/990de4b5.html>